



General Features

Description: LED fitting for lighting paths and urban spaces
Insulation class: class II
Rated voltage: 220-240 V 50/60 Hz
Protection Grade: IP66
Impact protection: IK09
Surge protection device: integrated 10kV-10kA
Power Factor: > 0.95
Ambient temperature Ta: -30°C +50°C
Weight: 6 kg
Max exposed surface: 0.119 m ²
Lateral exposed surface: 0.026 m ²
Common mode surge protection: 10 kV
Overvoltage protection differential mode: 10 kV
Drivers: included
Lifetime driver: F10 >100.000h @Ta25°C
Marks and Certifications: CE / ENEC (pending)



Performance Data*

Source flow:	4975 lm
Source power:	33.5 W
Source efficiency:	149 lm/W
Device flow:	4280 lm
Device power:	37 W
Appliance efficiency:	116 lm/W
Glare Index Category:	D6

Optical System

Source: LED R1
Color Temperature: 2200 K
Color Rendering Index (CRI): ≥ 70
Color Consistency (SDCM): ≤ 3
Type of optics: ME-06 Medium street with sidewalk
Optical group life: >100.000h @ Ta 25°C L90B10
Photobiological safety class: EXEMPT GROUP
ULOR: 0%
DLOR: 100%
Light intensity category: G*3

Normative References

EN60598-1, EN60598-2-3, EN61547, EN62471, EN55015, EN61000-3-2, EN61000-3-3

Installation and maintenance

Installation: pole side
Pole diameter: Ø 60 - 76 - 102 mm
Tilt: with adjustable joint can be tilted from -70° to +90° and rotated by 0° / 180°. The pointing and locking system is continuously adjustable.
Ø power cable: 10 ÷ 14 mm
Cable Gland: PG16
Power supply compartment: independent from the optical group

Flow adjustment

Standard On request

Virtual Midnight Teaching	X
Constant flow output (CLO)	X
Adjusting 1-10V	X
DALI control	X
Mains voltage variation	X
Wireless remote management	X
Provision for motion/light sensors	X

Materials

Body: die-cast aluminium alloy UNI EN AB 47100 (copper content < 1%)
Screen: tempered flat glass 4 mm
Lenses: high-transparency PMMA
Fixing system: die-cast aluminium alloy UNI EN AB 47100 (copper content < 1%)
Seals: anti-age silicone
Screws: stainless steel AISI 304
Finish: phospho-chromatation treated and polyester powder-coated in 16 phases to increase weather resistance

Colors

■ Sablé 100 Noir	Code: 06LN2B272123CHM4
------------------	-------------------------------

Complements

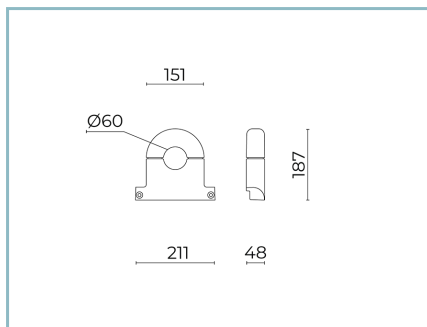

06LN902C0

B226 Single collar
for poles Ø60mm. Colour: Sablè 100
Noir.

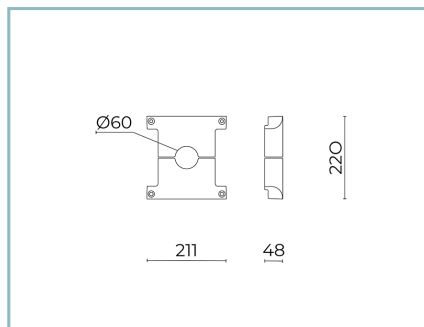

06LN905C0

B229 Double collar
for poles Ø60mm. Colour: Sablè 100
Noir.

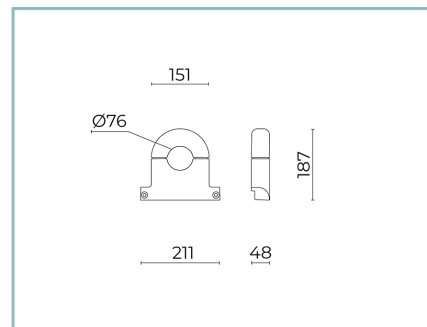

06LN903C0

B227 Single collar
for poles Ø76mm. Colour: Sablè 100
Noir.

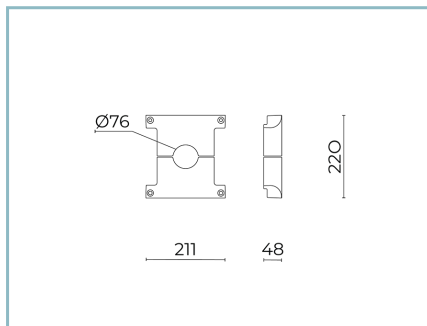

06LN906C0

B230 Double collar
for poles Ø76mm. Colour: Sablè 100
Noir.

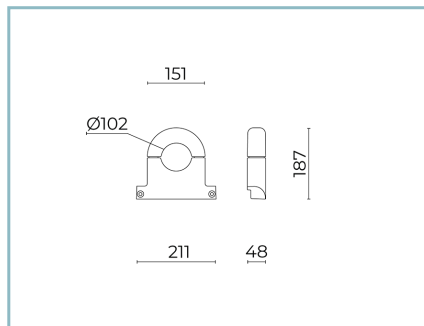

06LN904C0

B228 Single collar
for poles Ø102mm. Colour: Sablè 100
Noir.

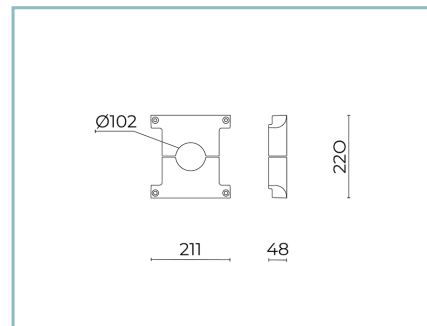

06LN907C0

B231 Double collar
for poles Ø102mm. Colour: Sablè 100
Noir.

NOTES

*Performance data

The values indicated in this data sheet are nominal values with a tolerance of +/-7%.

Source flux and source efficiency data refer to the LED module without optics; in case you are interested in the performance of the LED module complete with optical system, you must multiply the data reported by the factor 0.9.

General Data

The characteristics of the product listed may be subject to change and must be confirmed when ordering.

In order to promote constant updating of its products, Cariboni Group reserves the right to make changes without prior notice.